

DIN SWING CHECK VALVE PN100

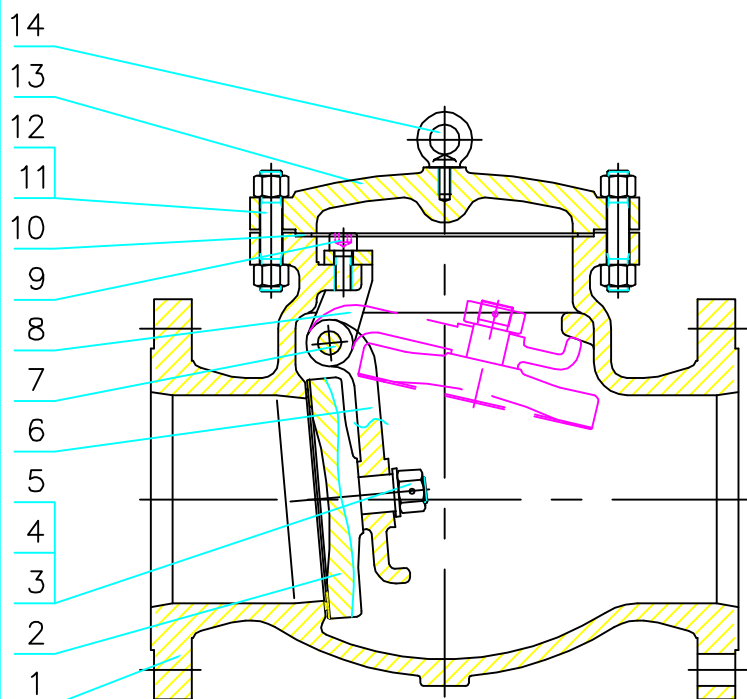

Standard and Specification/标准与规范			
Design standard 设计标准	Face to Face 结构长度	Flange connection 法兰连接	Testing standard 试验与检验
DIN 3356	DIN 3202	DIN2543-2547	DIN 3230

Performance Specification/性能规范				
PN(MPa)	Shell Test(MPa)	Sealing Test(MPa)	Temperture (°C)	Medium
10.0	15.0	11.00	-29°C~425°C	Water, Steam, Oil, Gas, etc. 水、蒸气、油品等

NO. 序号	Name/名称	Material/材料					
1	Body/阀体	GS-C25+13Cr	1.4308	1.4408	CF3	CF3M	LCC+STL
2	Disc/阀瓣	1045+13Cr	1.4301	1.4401	F304L	F316L	1045+STL
3	Gasket/垫片	Fe360B	304	316	304L	316L	Fe360B
4	Nuts/六角螺母	A194 2H	A194 8	A194 8	A194 8	A194 8	1035
5	Split Pin/开口销	Fe360B	304	304	304	304	35CrMoA
6	Hinge/摇杆	GS-C25	1.4308	1.4408	CF3	CF3M	LCC
7	Pin/销轴	1.4021	F304	F316	F304L	F316L	F304
8	Yoke/支架	GS-C25	1.4308	1.4408	CF3	CF3M	LCC
9	Bolt/内六角螺钉	A193 B7	A194 8	A194 8	A194 8	A194 8	A193 B7
10	Gasket/复合垫片	304+GRAPHITE	304+GRAPHITE	304+GRAPHITE	304+GRAPHITE	304+GRAPHITE	304+GRAPHITE
11	Bolts/双头螺栓	A193 B7	A193 B8	A193 B8	A193 B8	A193 B8	A193 B7
12	Nuts/六角螺母	A194 2H	A194 8	A194 8	A194 8	A194 8	A194 2H
13	Bonnet/阀盖	GS-C25	1.4308	1.4408	CF3	CF3M	LCC
14	Eyebolt/吊环螺钉	A193 B7	A193 B7	A193 B7	A193 B7	A193 B7	A193 B7

DIN S/WING CHECK VALVE PN100

11

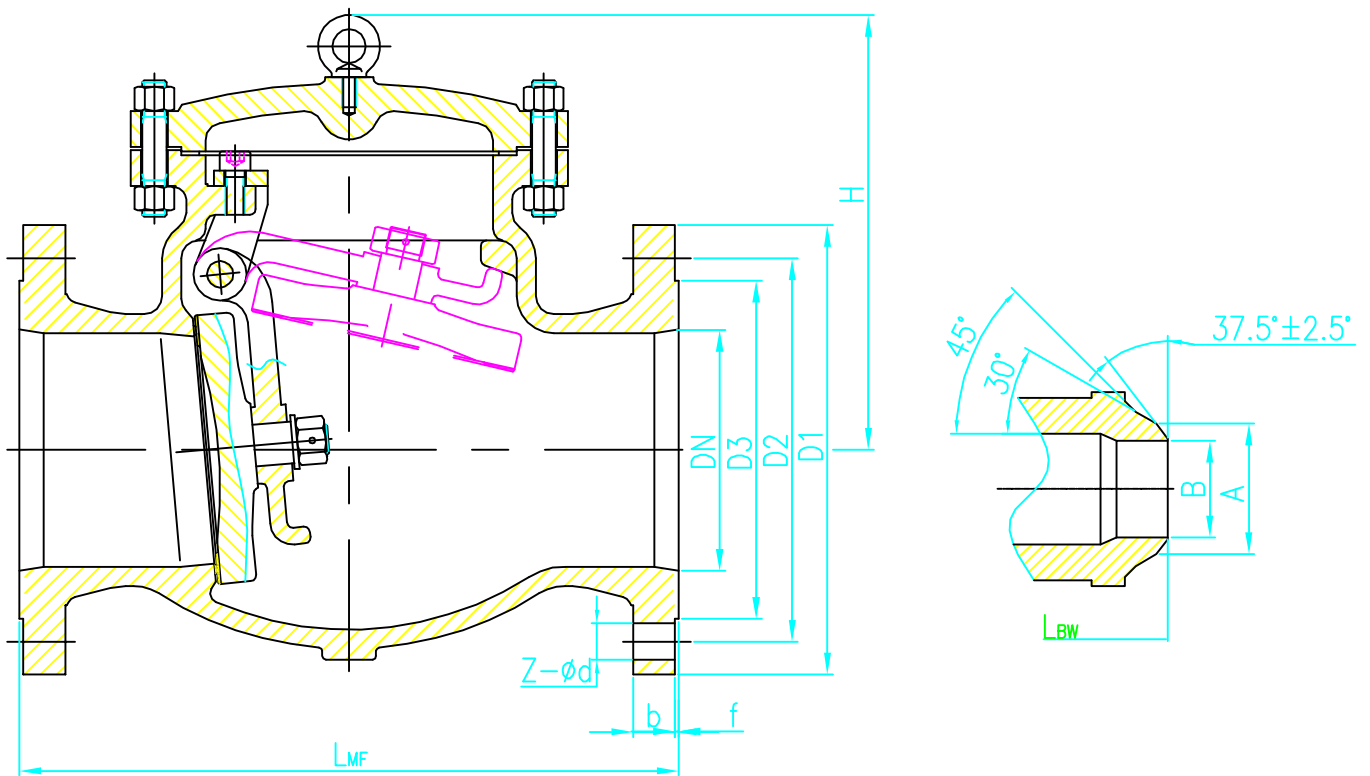

H44 (H, Y, W) -100 (C, P, R, I)

DN	LMF	LBW	D(φ)	D1(φ)	D2(φ)	f	b	Z-φd	A	B	H
50	300	300	195	145	87	4	28	4-φ26	60	49	210
65	340	340	220	170	109	4	30	8-φ26	75	59	225
80	380	380	230	180	120	4	32	8-φ26	91	74	275
100	430	430	265	210	149	4.5	36	8-φ30	117	97	308
125	500	500	315	250	175	4.5	40	8-φ33	144	122	645
150	550	550	355	290	203	4.5	44	12-φ33	172	146	405
200	650	650	430	360	259	4.5	52	12-φ36	223	194	435
250	775	775	505	430	312	4.5	60	12-φ39	278	243	485
300	900	900	585	500	363	4.5	68	16-φ42	329	298	505
350	1025	1025	655	560	421	5	74	16-φ48	362	330	548
400	1150	1150	715	620	473	5	82	16-φ48	413	373	632