

DIN SWING CHECK VALVE PN40

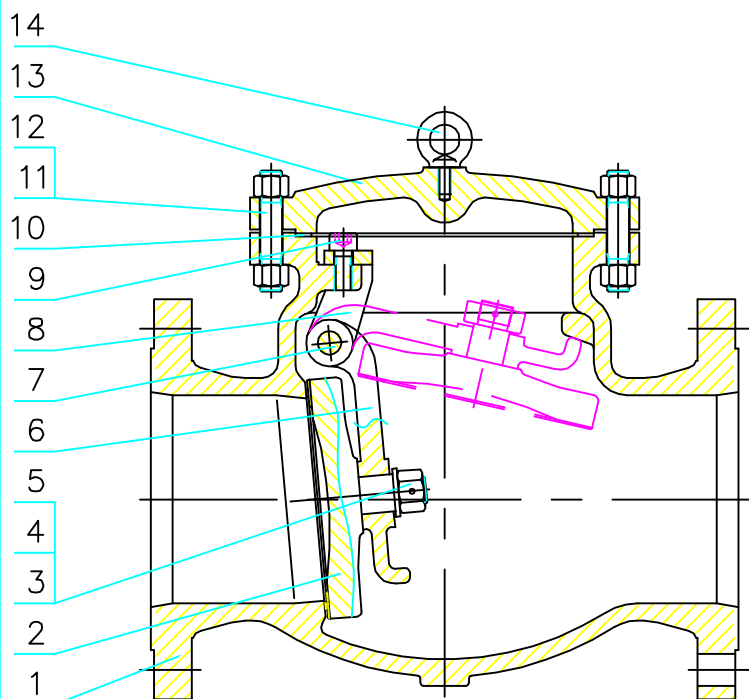

Standard and Specification/标准与规范			
Design standard 设计标准	Face to Face 结构长度	Flange connection 法兰连接	Testing standard 试验与检验
DIN 3356	DIN 3202	DIN2543-2547	DIN 3230

Performance Specification/性能规范				
PN(MPa)	Shell Test(MPa)	Sealing Test(MPa)	Temperature(°C)	Medium
4.0	6.0	4.40	-29°C~425°C	Water, Steam, Oil, Gas, etc. 水、蒸气、油品等

NO. 序号	Name/名称	Material/材料					
1	Body/阀体	GS-C25+13Cr	1.4308	1.4408	CF3	CF3M	LCC+STL
2	Disc/阀瓣	1045+13Cr	1.4301	1.4401	F304L	F316L	1045+STL
3	Gasket/垫片	Fe360B	304	316	304L	316L	Fe360B
4	Nuts/六角螺母	A194 2H	A194 8	A194 8	A194 8	A194 8	1035
5	Split Pin/开口销	Fe360B	304	304	304	304	35CrMoA
6	Hinge/摇杆	GS-C25	1.4308	1.4408	CF3	CF3M	LCC
7	Pin/销轴	1.4021	F304	F316	F304L	F316L	F304
8	Yoke/支架	GS-C25	1.4308	1.4408	CF3	CF3M	LCC
9	Bolt/内六角螺钉	A193 B7	A194 8	A194 8	A194 8	A194 8	A193 B7
10	Gasket/复合垫片	304+GRAPHITE	304+GRAPHITE	304+GRAPHITE	304+GRAPHITE	304+GRAPHITE	304+GRAPHITE
11	Bolts/双头螺栓	A193 B7	A193 B8	A193 B8	A193 B8	A193 B8	A193 B7
12	Nuts/六角螺母	A194 2H	A194 8	A194 8	A194 8	A194 8	A194 2H
13	Bonnet/阀盖	GS-C25	1.4308	1.4408	CF3	CF3M	LCC
14	Eyebolt/吊环螺钉	A193 B7	A193 B7	A193 B7	A193 B7	A193 B7	A193 B7

DIN SWING CHECK VALVE PN40

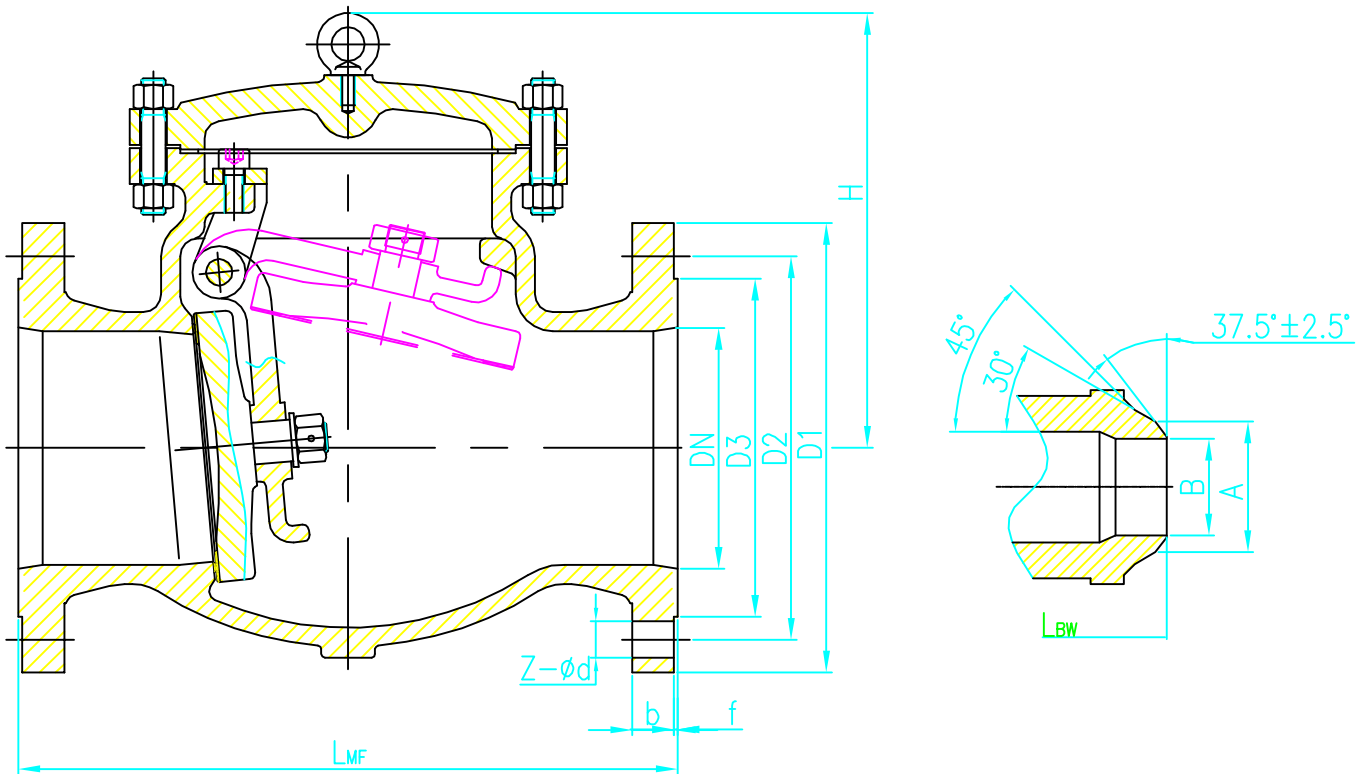

H44 (H, Y, W) -40 (C, P, R, I)

DN	LMF	LBW	D(φ)	D1(φ)	D2(φ)	f	b	Z-φd	A	B	H
50	230	230	165	125	87	4	20	4-φ18	60	52	160
65	290	290	185	145	109	4	22	8-φ18	75	63	175
80	310	310	200	160	120	4	24	8-φ18	91	78	185
100	350	350	235	190	149	4.5	24	8-φ22	117	102	220
125	400	400	270	220	175	4.5	26	8-φ26	144	128	250
150	480	480	300	250	203	4.5	28	8-φ26	172	154	270
200	600	600	375	320	259	4.5	34	12-φ30	223	203	350
250	730	730	450	385	312	4.5	38	12-φ33	278	255	410
300	850	850	515	450	363	4.5	42	16-φ33	329	305	430
350	980	980	580	510	421	5	46	16-φ36	362	337	520
400	1100	1100	660	585	473	5	50	16-φ39	413	387	560
450	1200	1200	685	610	523	5	57	20-φ39	464	438	590
500	1250	1250	755	670	575	5	57	20-φ42	516	489	620